

Displacement diffuser DINO-K

DINO-K Quick guide

- < 25 dB
- 25 - 30 dB
- 30 - 35 dB

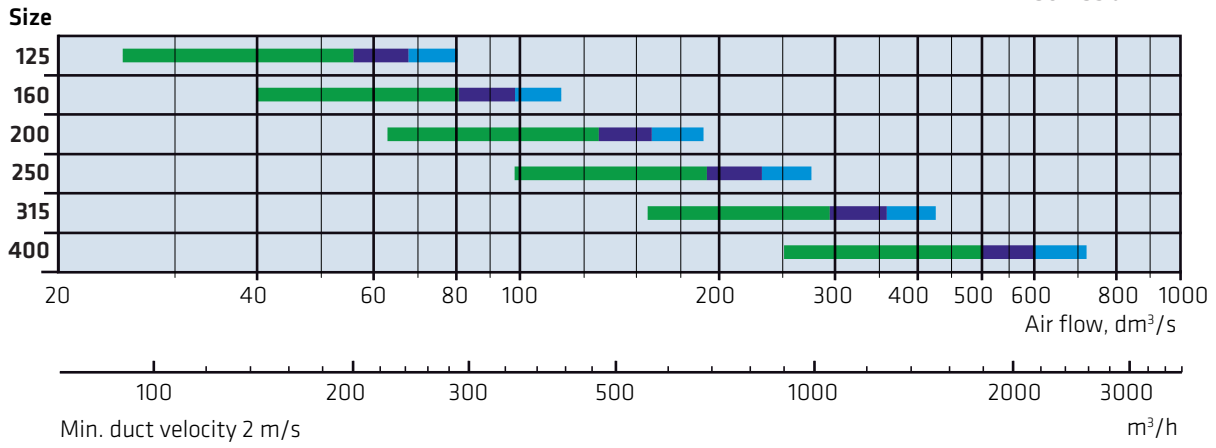

Displacement diffuser DINO-K

Main dimensions

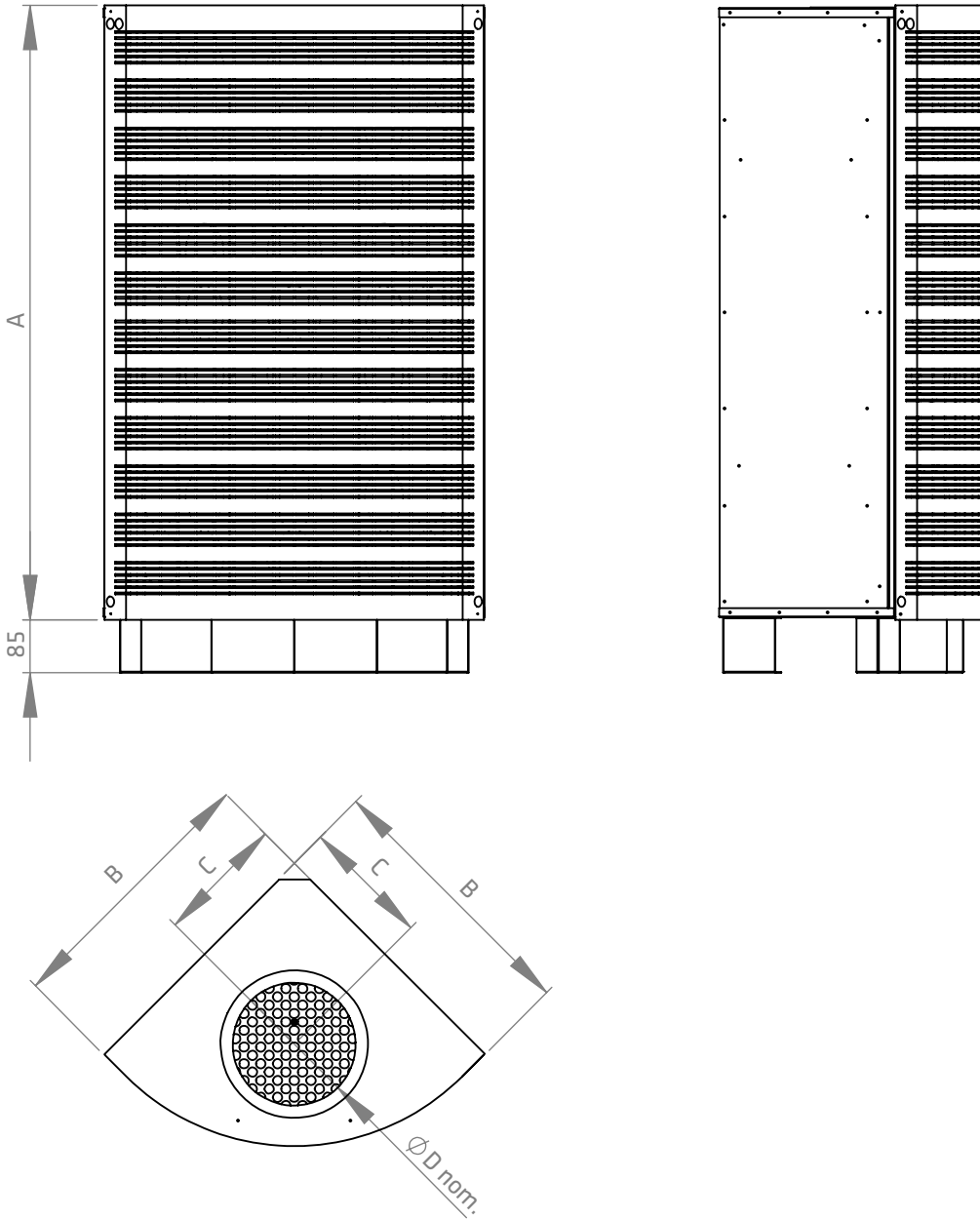

Size	A	B	C	ØD nom.	Weight/kg
125	600	336	160	125	9
160	600	336	147	160	9
200	1000	440	208	200	16,5
250	1000	440	190	250	16,5
315	1500	506	214	315	27
400	2000	526	264	400	42,5

Displacement diffuser DINO-K

Main dimensions, duct parts

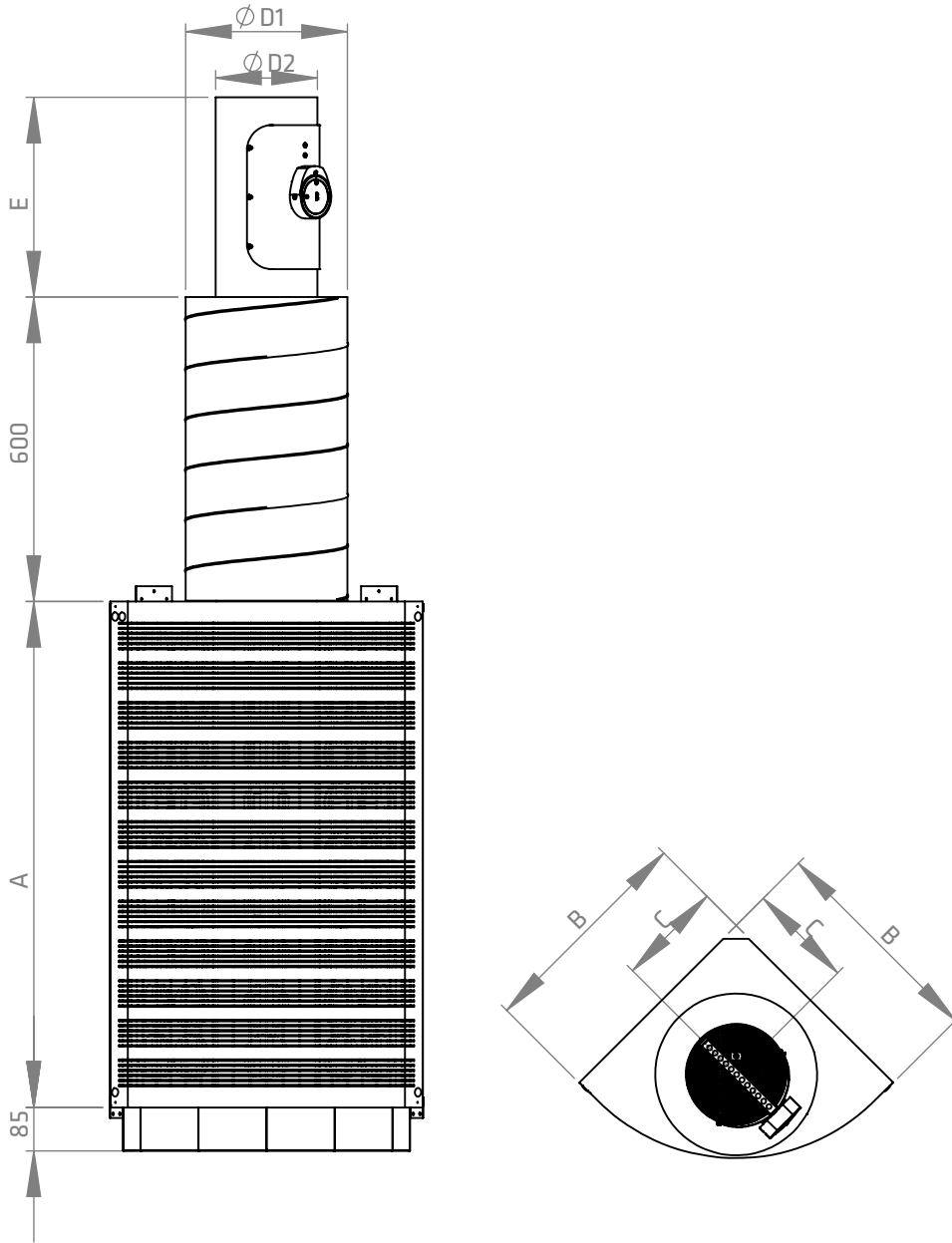

Size	A	B	C	ØD1	ØD2 nom.	E	Weight/kg
125	600	336	160	230	125	340	15
160	600	336	147	285	160	365	17,5
200	1000	440	208	320	200	395	27
250	1000	440	190	370	250	435	29
315	1500	506	214	415	315	185	15,5
400	2000	526	264	515	400	210	62,5

NB! In size 400 the damper is DIRIS.

Displacement diffuser DINO-K

Main dimensions, Duct cover

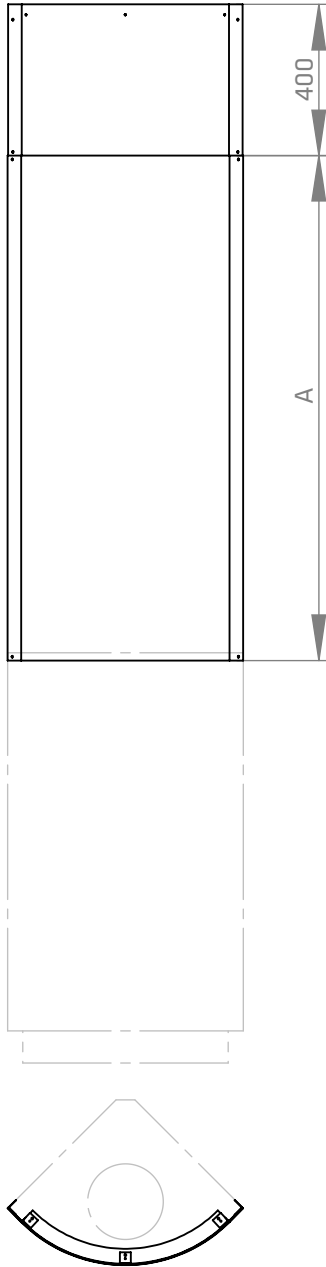

Size	A	Ceiling height/mm	Weight/kg
125	1735	2400-2800	11,5
160	1735	2400-2800	11,5
200	1335	2400-2800	12
250	1335	2400-2800	12
315	1335	2900-3300	13,5
400	1335	3400-8800	16

Displacement diffuser DINO-K

Coupling directions

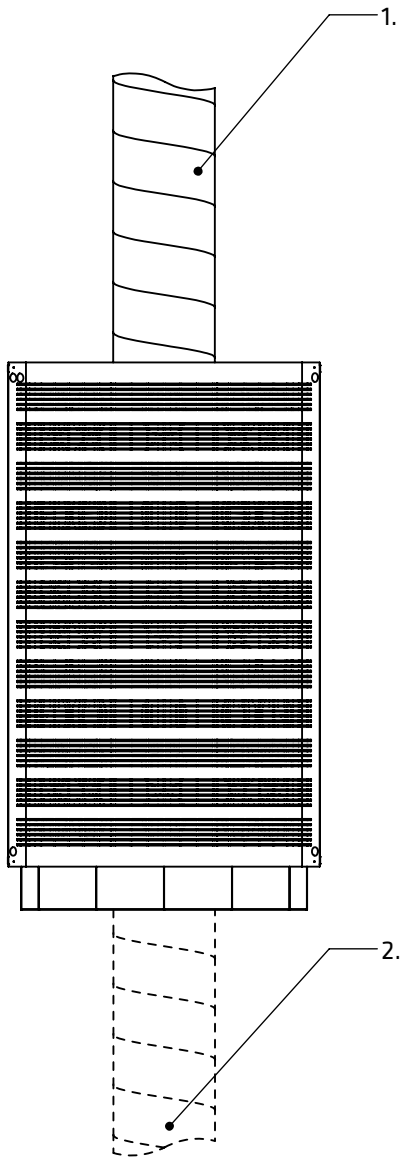

Displacement diffuser DINO-K

DINO A throw pattern can be changed

Throw pattern directed along wall surface

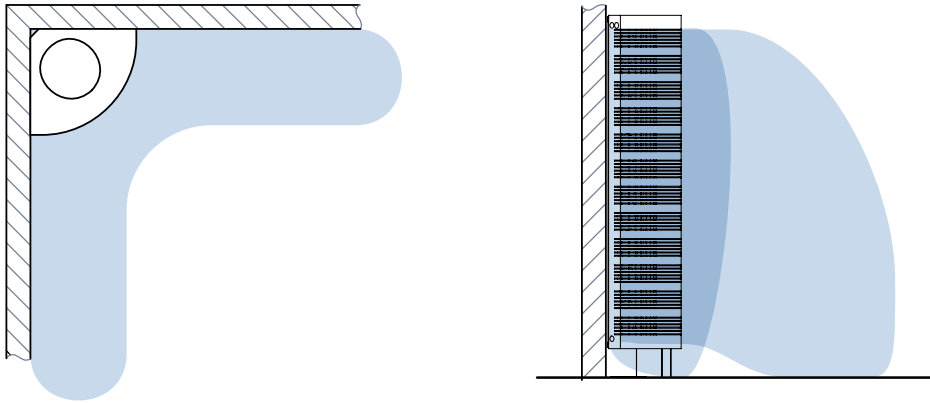

Forward throw pattern

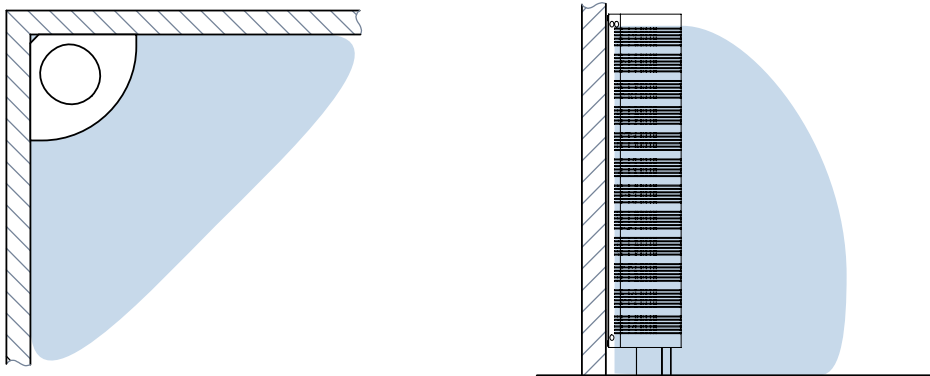

Sideways throw pattern

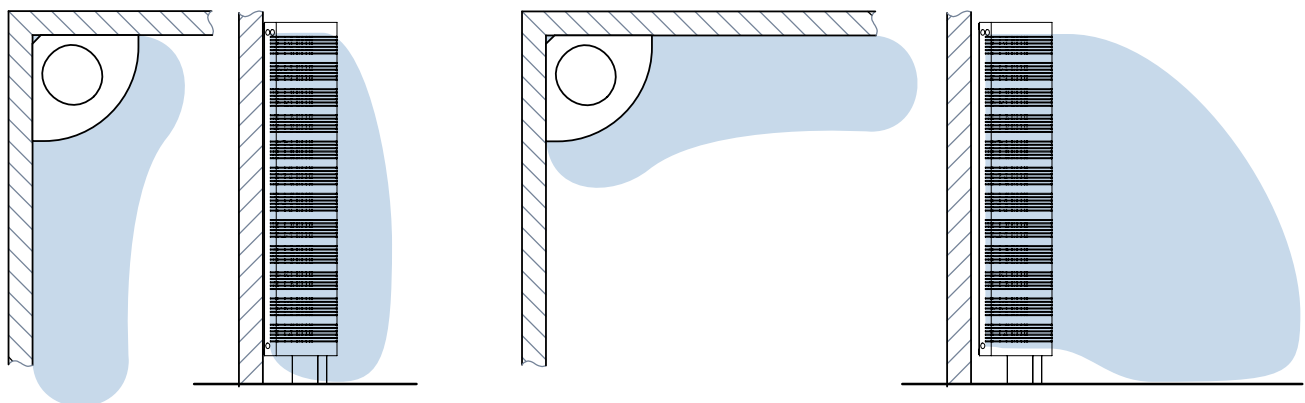

Displacement diffuser DINO-K

Throw pattern graphs

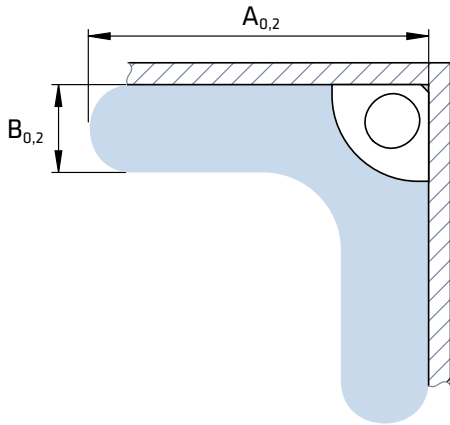

DINO-K Affected area ($L_{0,2m}$), direction A, $\Delta t=-3$, Duct velocity 2-6 m/s

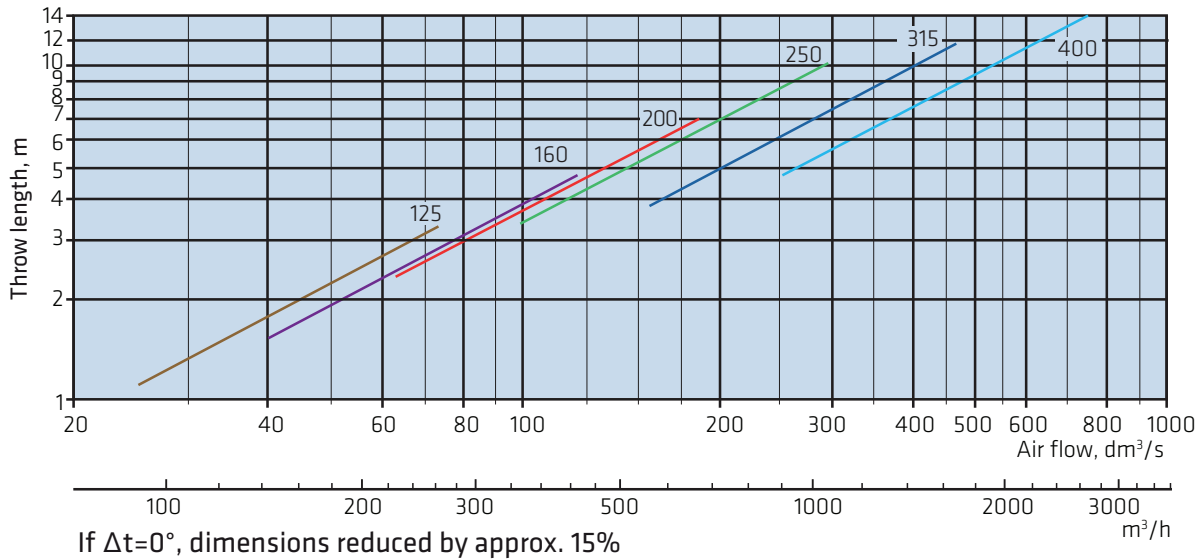

DINO-K Affected area ($L_{0,2m}$), direction B, $\Delta t=-3$, Duct velocity 2-6 m/s

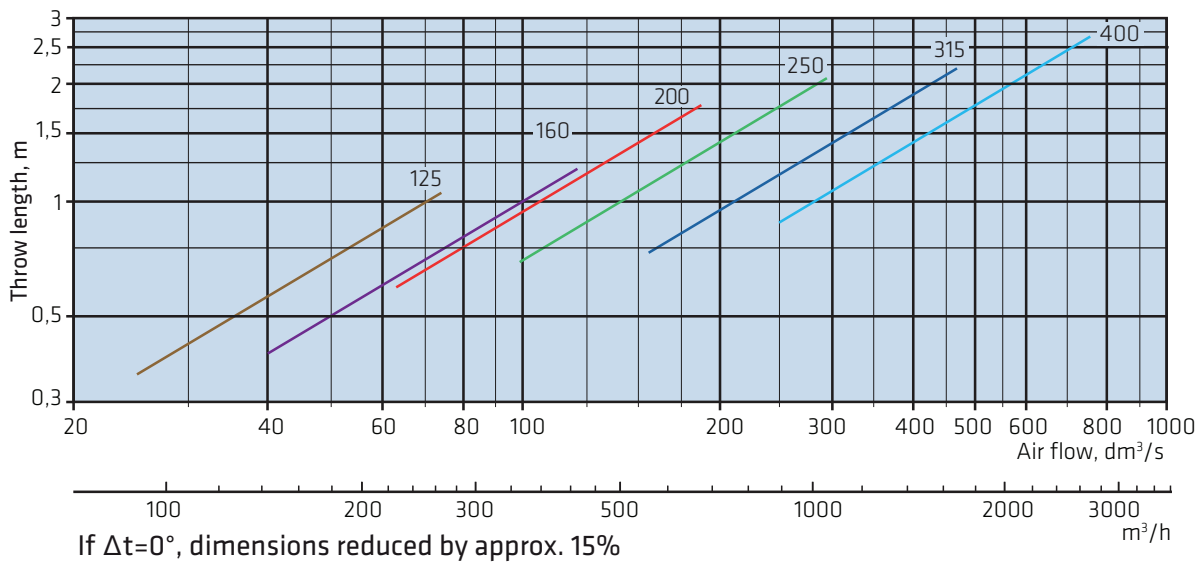

Displacement diffuser DINO-K

Dimensioning

The graphs are not intended for adjustment.

DINO-K 125 - 400

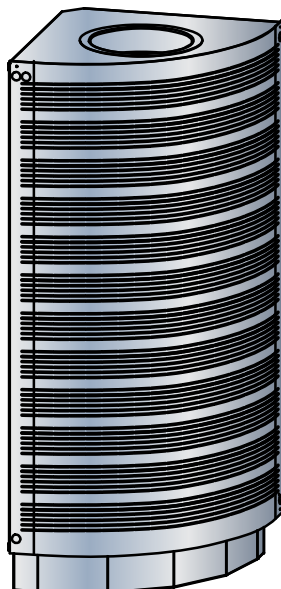
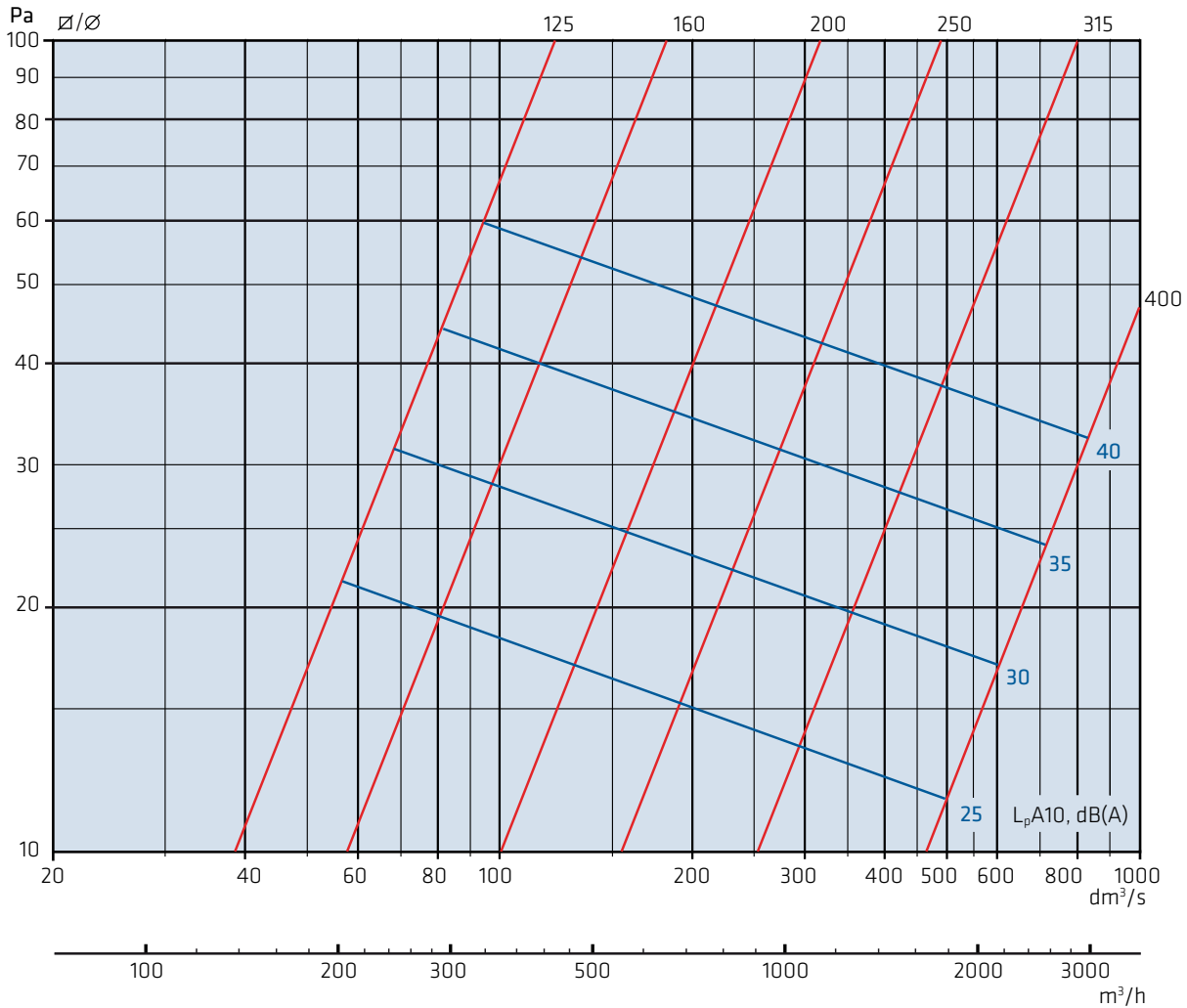

Displacement diffuser DINO-K

Dimensioning

The graphs are not intended for adjustment.

DINO-K 125 + Damper + Sound attenuator

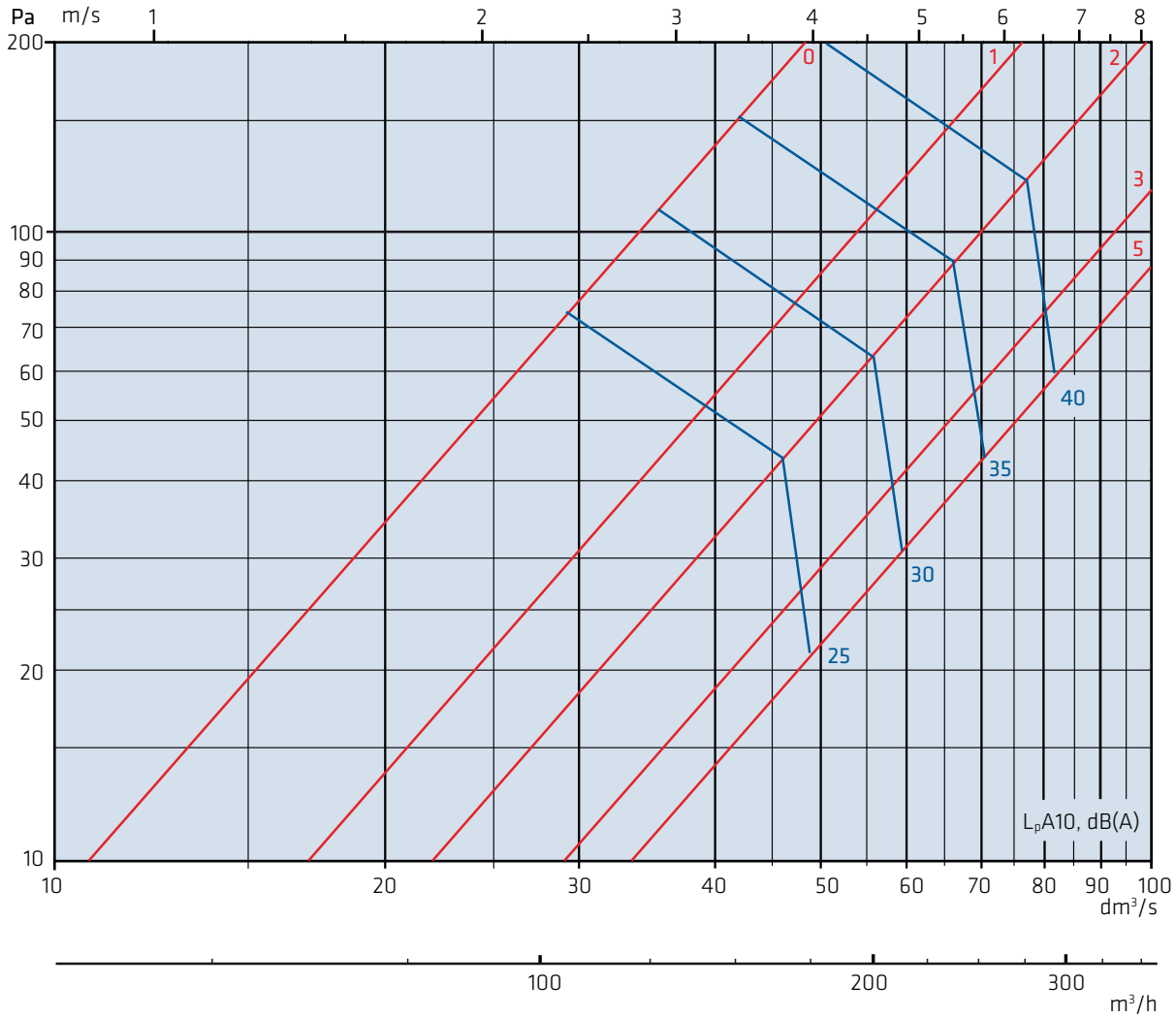

Sound power level	$L_{w\text{okt}} = L_{pA10} + K$
Size	f, Hz 63 125 250 500 1k 2k 4k 8k
DINO-K 125	K, dB 10 10 11 -3 -7 -9 -11 -9

Sound attenuation	
Size	f, Hz 63 125 250 500 1k 2k 4k 8k
DINO-K 125	ΔL , dB 17 11 4 5 4 4 5 7
DINO-K 125 + SA	ΔL , dB 17 11 13 23 30 20 19 20

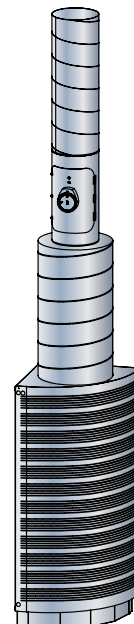

Displacement diffuser DINO-K

Dimensioning

The graphs are not intended for adjustment.

DINO-K 160 + Damper + Sound attenuator

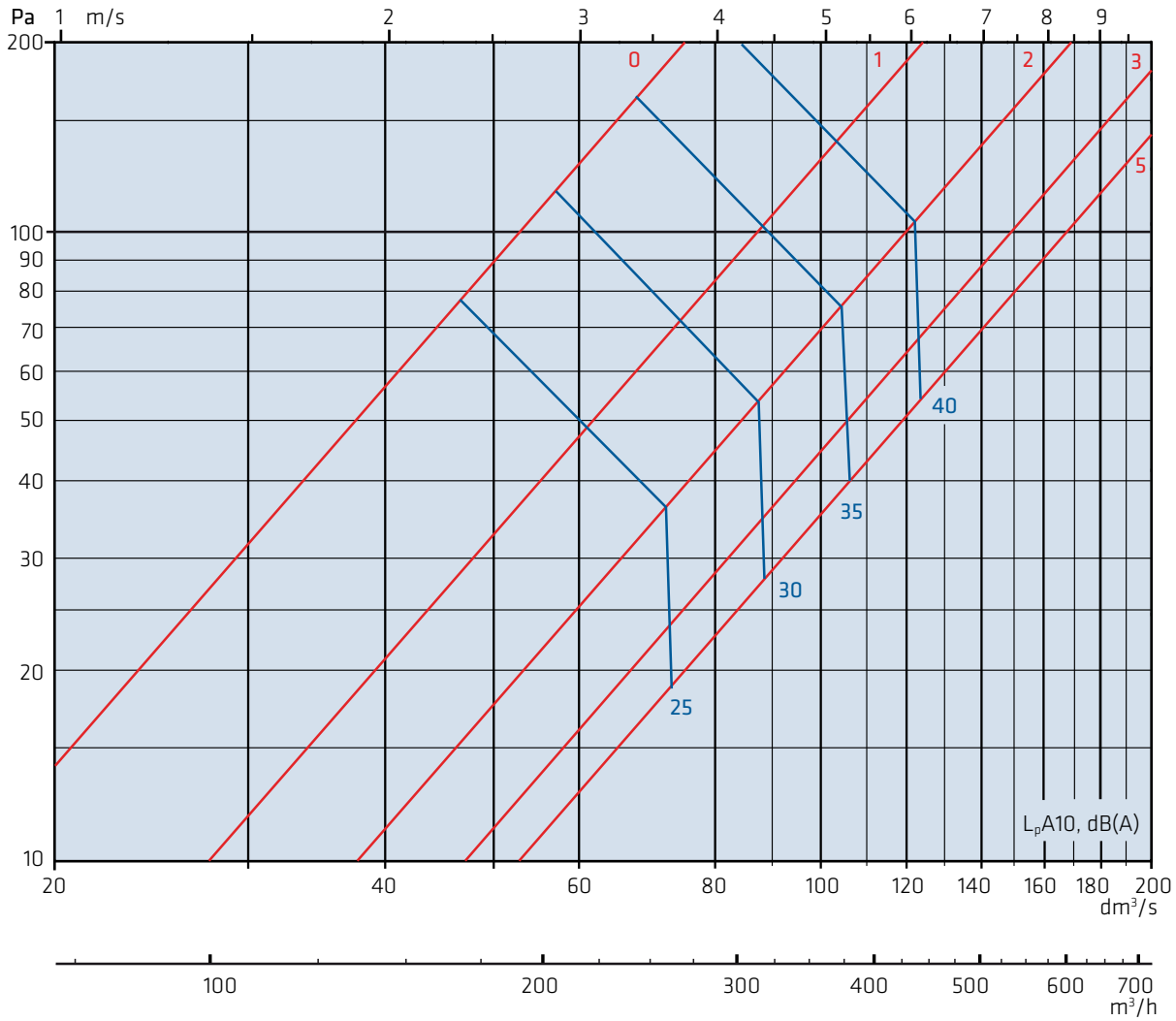

Sound power level	$L_{w_{okt}} = L_{pA10} + K$
Size	f, Hz 63 125 250 500 1k 2k 4k 8k
DINO-K 160	K, dB 9 10 10 -1 -6 -10 -11 -11

Sound attenuation	
Size	f, Hz 63 125 250 500 1k 2k 4k 8k
DINO-K 160	ΔL , dB 15 10 4 4 3 3 4 8
DINO-K 160 + SA	ΔL , dB 15 11 13 22 29 20 19 20

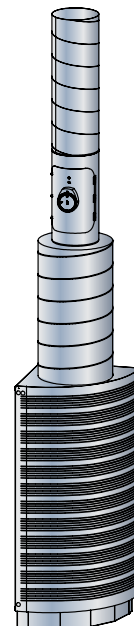

Displacement diffuser DINO-K

Dimensioning

The graphs are not intended for adjustment.

DINO-K 200 + Damper + Sound attenuator

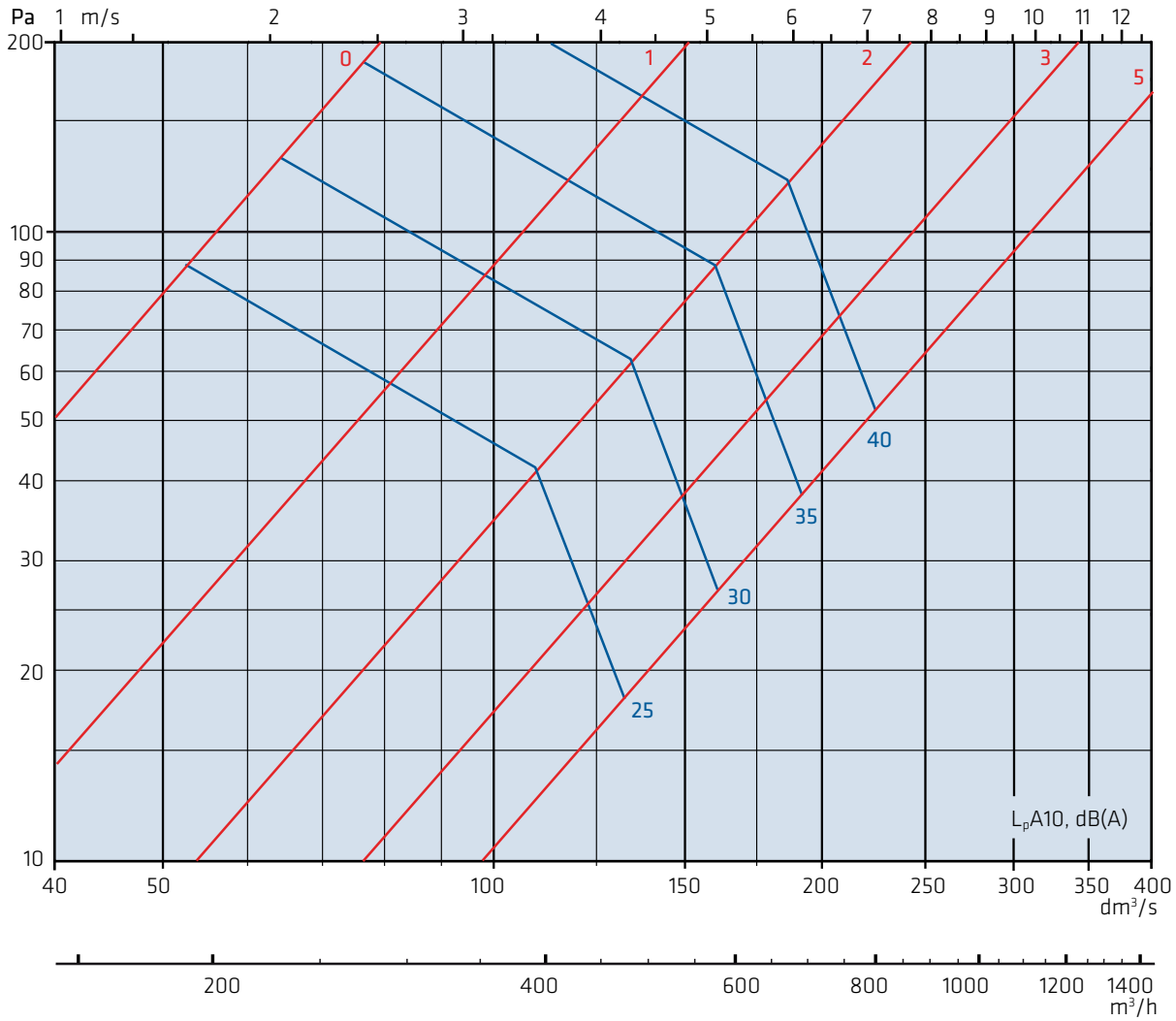

Sound power level	$L_{w\text{okt}} = L_{pA10} + K$
Size	f, Hz 63 125 250 500 1k 2k 4k 8k
DINO-K 200	K, dB 7 9 9 0 -5 -9 -12 -12

Sound attenuation	
Size	f, Hz 63 125 250 500 1k 2k 4k 8k
DINO-K 200	ΔL , dB 16 9 3 4 3 3 4 7
DINO-K 200 + SA	ΔL , dB 16 12 11 21 28 18 17 18

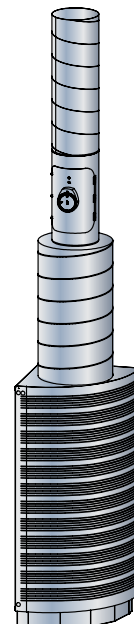

Displacement diffuser DINO-K

Dimensioning

The graphs are not intended for adjustment.

DINO-K 250 + Damper + Sound attenuator

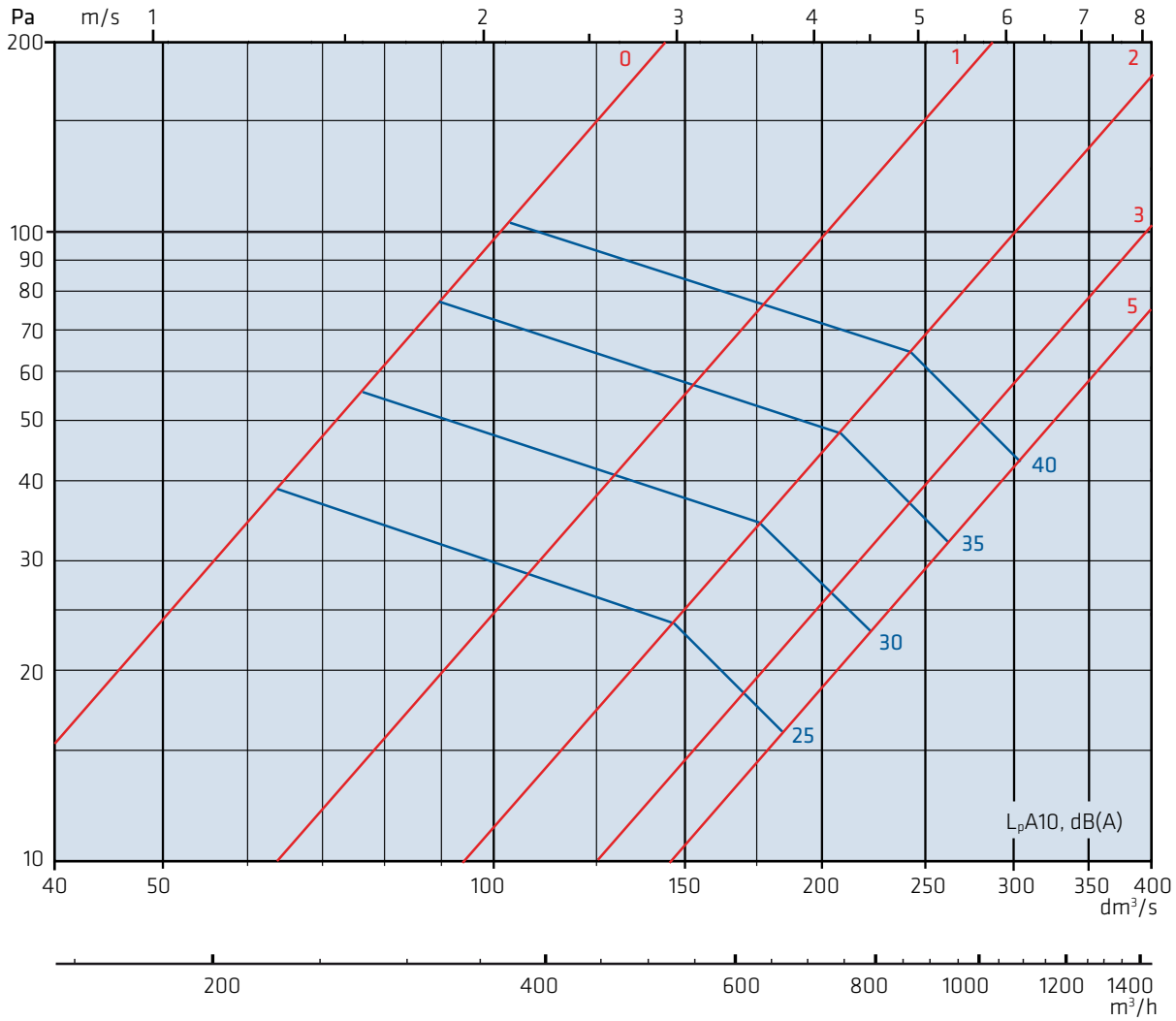

Sound power level		$L_{w\text{okt}} = L_{pA10} + K$							
Size	f, Hz	63	125	250	500	1k	2k	4k	8k
DINO-K 250	K, dB	6	8	9	2	-3	-9	-13	-20

Sound attenuation									
Size	f, Hz	63	125	250	500	1k	2k	4k	8k
DINO-K 250	ΔL , dB	14	7	2	2	2	1	3	5
DINO-K 250 + SA	ΔL , dB	14	8	9	19	26	16	15	15

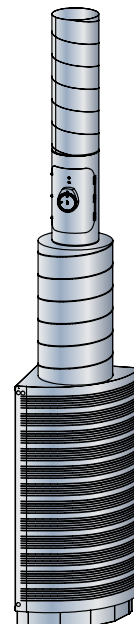

Displacement diffuser DINO-K

Dimensioning

The graphs are not intended for adjustment.

DINO-K 315 + Damper + Sound attenuator

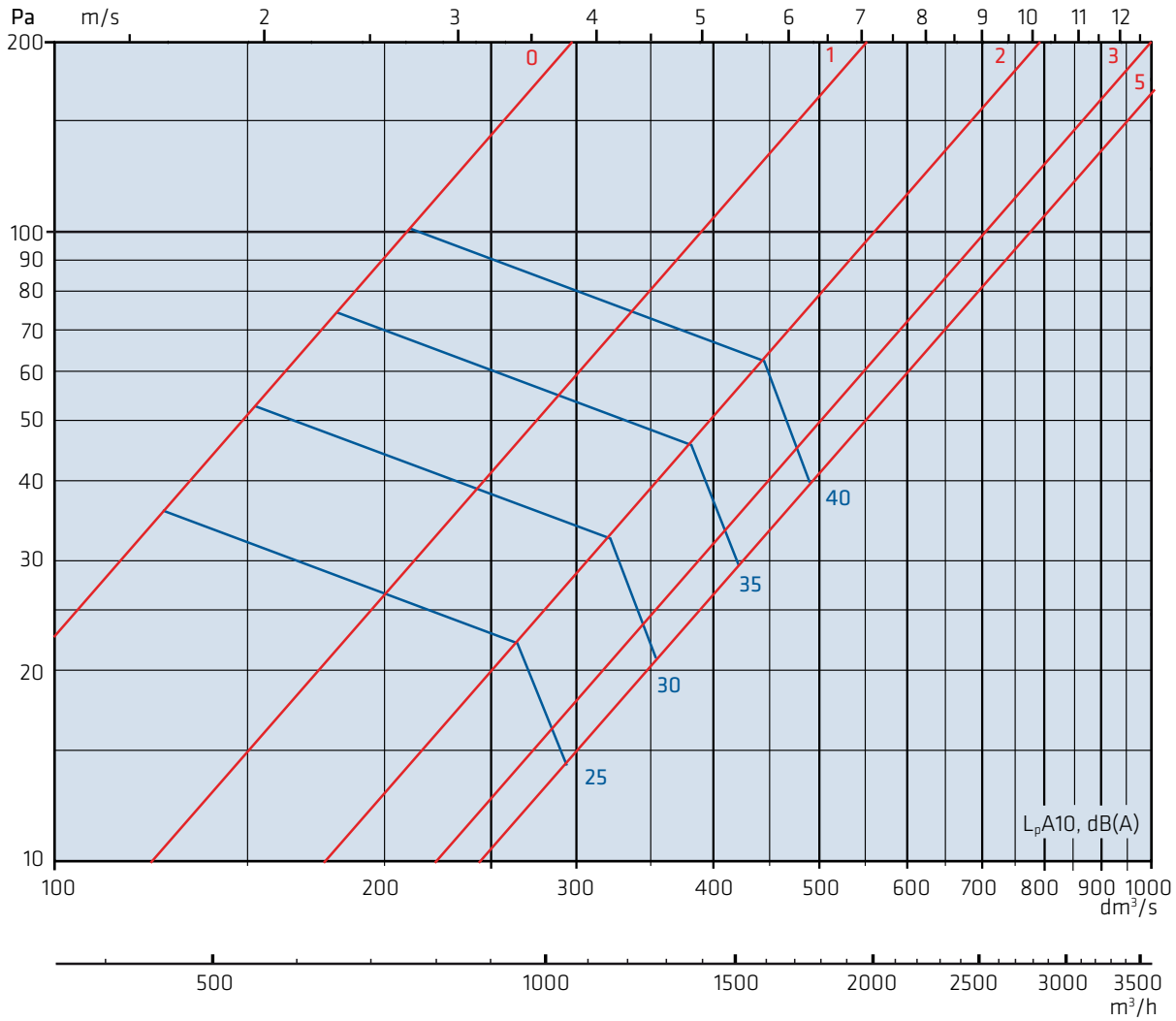

Sound power level		$L_{w\text{okt}} = L_{pA10} + K$							
Size	f, Hz	63	125	250	500	1k	2k	4k	8k
DINO-K 315	K, dB	1	7	8	2	-3	-10	-14	-24

Sound attenuation									
Size	f, Hz	63	125	250	500	1k	2k	4k	8k
DINO-K 315	ΔL , dB	10	5	0	1	2	1	2	4
DINO-K 315 + SA	ΔL , dB	9	6	5	11	15	13	10	13

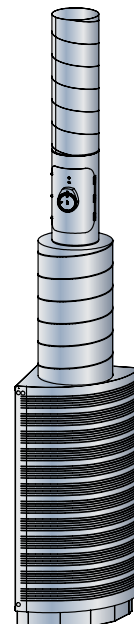

Displacement diffuser DINO-K

Dimensioning

The graphs are not intended for adjustment.

DINO-K 400 + Damper + Sound attenuator

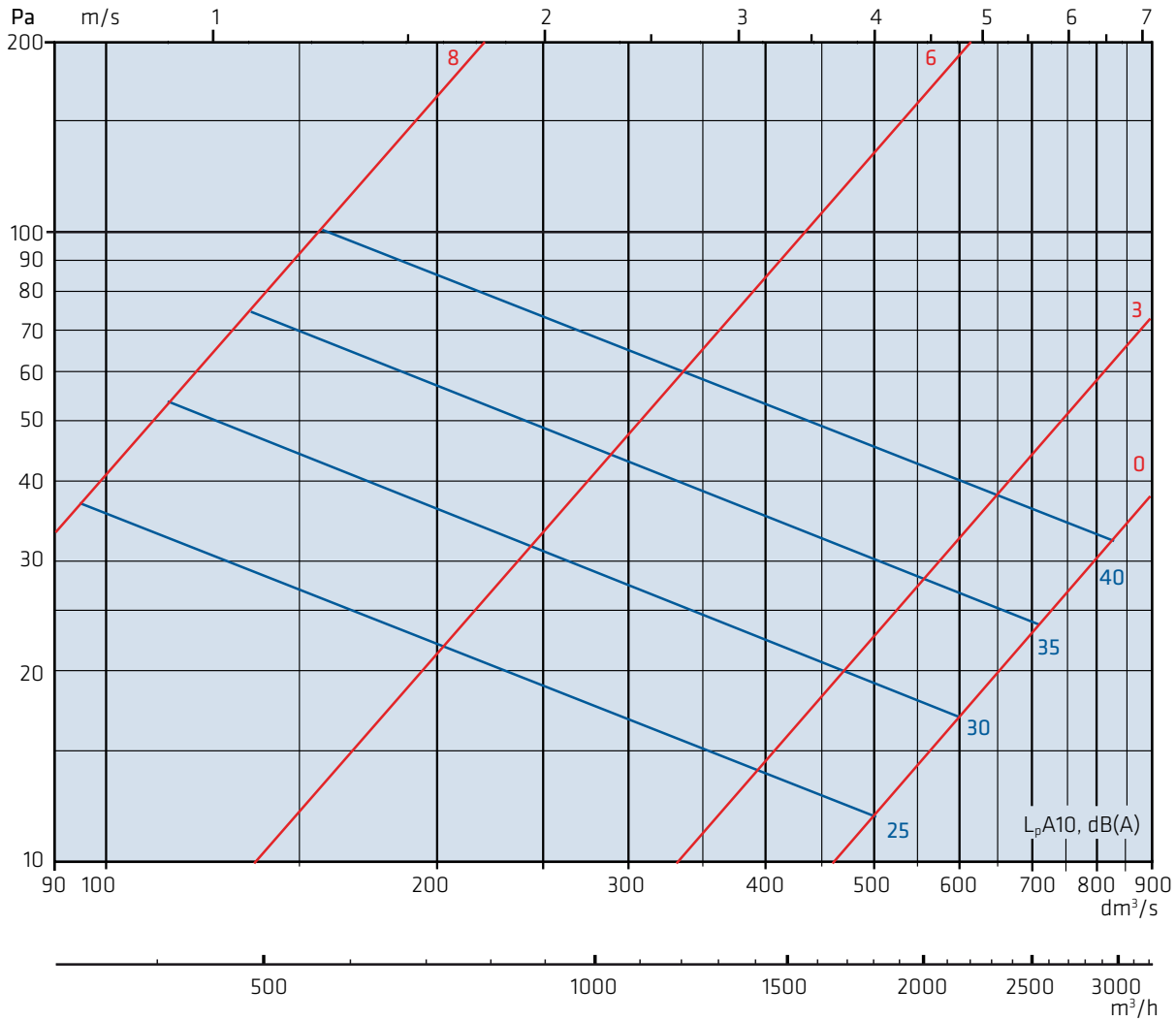

Sound power level		$L_{w\text{okt}} = L_{pA10} + K$							
Size	f, Hz	63	125	250	500	1k	2k	4k	8k
DINO-K 400 + SA	K, dB	2	8	8	3	-2	-10	-13	-25

Sound attenuation									
Size	f, Hz	63	125	250	500	1k	2k	4k	8k
DINO-K 400 + SA	ΔL , dB	8	4	0	1	1	1	1	2
DINO-K 400 + SA	ΔL , dB	8	4	3	9	14	12	9	13

